

UNIVERSAL TUBE BURNER CARE AND SAFETY INSTRUCTIONS

REPLACES MOST TUBE BURNERS FROM 14" - 19 1/2" (35.5 CM - 49.5 CM)

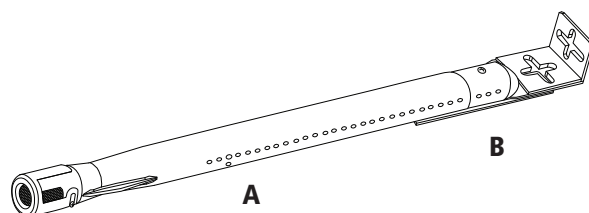

FOR YOUR SAFETY

▲ DANGER: READ ALL INSTRUCTIONS PRIOR TO INSTALLATION AND USE OF THIS BURNER. FAILURE TO FOLLOW THESE INSTRUCTIONS MAY RESULT IN AN EXPLOSION OR FIRE THAT MAY CAUSE PROPERTY DAMAGE, SERIOUS INJURY OR DEATH.

▲ CAUTION: IF THE BURNER ASSEMBLY DOES NOT FIT, RETURN TO THE PLACE OF PURCHASE TO OBTAIN A CORRECT BURNER FOR YOUR BARBECUE.

▲ ATTENTION: MOVE BARBECUE TO AN OPEN OUTDOOR AREA PRIOR TO REMOVING OLD BURNERS AND INSTALLING YOUR NEW REPLACEMENT BURNERS. ENSURE BARBECUE IS COOL BEFORE PROCEEDING, AND CLOSE THE CONTROL KNOB(S) AND GAS SUPPLY.

PART #	DESCRIPTION	QUANTITY		
A	Front burner tube	1		
B	Rear burner tube	1		
C	90° bracket	1		
D	Flame crossover bracket	1		
E	Large round washer	3		
F	Large bolt	2		
G	Large nut	3		
H	Small bolt	3		
I	Small round washer	3		
J	Spring pin	1		

ASSEMBLY INSTRUCTIONS:

TOOLS REQUIRED: PHILIPS SCREWDRIVER, PLIERS OR LOCKING WRENCH.

1 Remove the cooking grates and heat plates to access burners. Remove old burner and flame crossover tube or ignitor electrode (if applicable), following the owners manual that came with the barbecue.

▲ Be sure to keep the hardware used to secure the burner as it may be required to secure the new burner into the barbecue.

2 Remove the small bolt (H) from the bottom of the burner tube (B), as shown, and set aside. The rear burner tube (B) and the front burner tube (A) will now slide freely. See Figure 1.

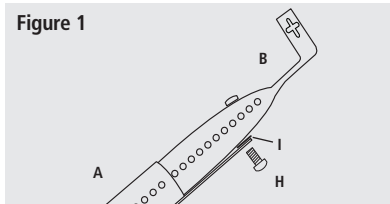

3 Extend parts (A) and (B) to match the length of the old burner. Parts (A) and (B) must line up so that bolt (H) can secure the two burner tubes together. Secure parts (A) and (B) with the small bolt (H). Double check to ensure that the port holes of the front burner tube (A) and the rear burner tube (B) are aligned. See Figure 2.

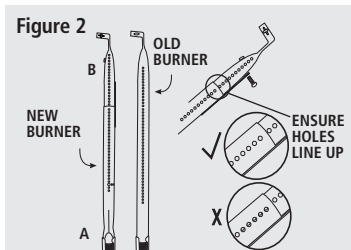

4 Secure the small washers (I) and small bolts (H) into the remaining holes on the bottom of the rear burner (B), if applicable. See Figure 3.

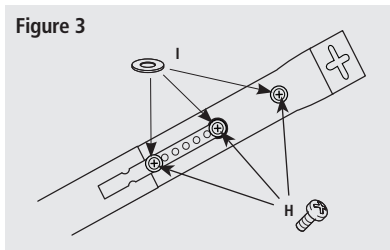

5 Adjust the air shutter on the front burner tube (A) to match the air shutter on the old burner. Loosen the air shutter screw on the front of burner tube (A) to adjust the air shutter opening to match the old burner. Re-tighten screw once complete. See Figure 4.

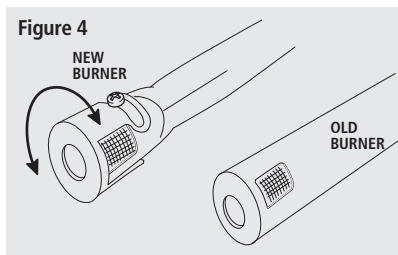

6 Install the new burner into your barbecue. Make sure the opening on the front burner (A) is properly aligned with the gas valve. Burner should slide 1/4" (0.63cm) onto the gas valve. See Figure 5.

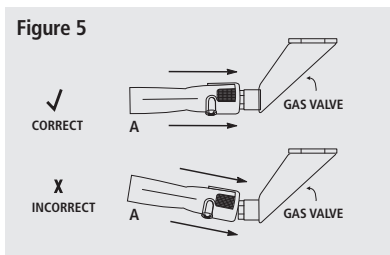

7 There are several types of mounting systems. Your new burner is designed to mount one of the following:

- A. SHELF MOUNT (See Figure 6A and 6B) OR WALL MOUNT (See Figure 7)** –Use the nut/bolt/washer or spring pin you removed from your old burner to secure the new burner to shelf support.
- B. RAISED MOUNT (See Figure 8)**—If you have a barbecue with a raised mount, fasten the 90° Bracket (C) to the burner using the large bolt (F), nut (G) and larger washer (E) supplied. Secure the 90° Bracket (C) to the raised shelf using your original nut/bolt/larger washer from your old burner.

NOTE: If you can not use the original nut/bolt/washer removed from the old burner (in Step #1 above), use the large bolt (F), nut (G) and larger washer (E) supplied.

CAUTION: If you are not able to mount the burner following the steps above, the burner is not compatible for your barbecue and should be returned to the retailer where purchased.

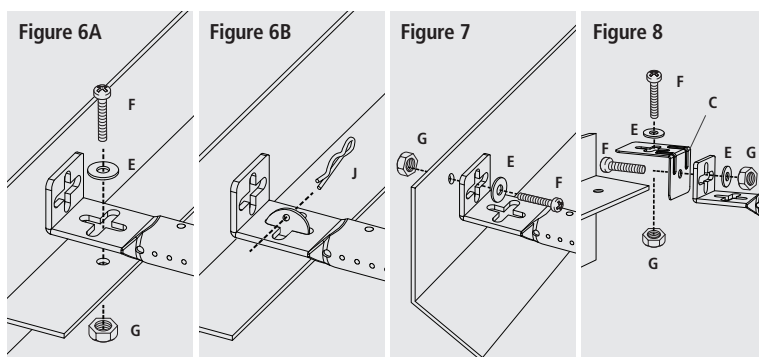

8 1. Some barbecues require a "flame crossover tube" to be attached directly to the burner. If the flame crossover tube is mounted at the back of the burner, remove the screw from the top of the rear burner tube (B) and place the Flame Crossover Tube into place and secure with the screw and a large round washer (E). See Figure 9.

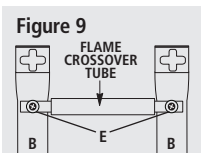

OR

2. If the flame crossover tube is mounted in a different location on the burner, you can use the flame crossover bracket (D) to reposition the flame crossover tube. Fasten the flame crossover bracket (D) to flame crossover tube with nut (G) and washer (E) and sit on burner as shown. See Figure 10.

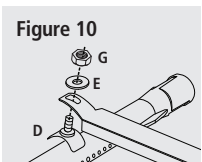

9 Reattach the ignitor electrode or install new electronic universal ignitor assembly. (With some ignitor brackets it be necessary to lightly squeeze / "crimp" the mounting bracket with pliers for better fit.)

Test the new burner by turning on the gas supply at the LP tank (or natural gas connection) first, then at your barbecues control knobs. Confirm that the flames are coming from the burner gas port holes only. The flames should be blue with yellow tips. See Figure 11.

NOTE: If you notice larger unruly flames. Readjust the air shutter, until flames appear as described.

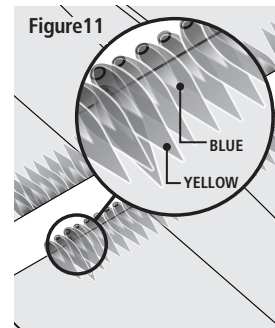

▲ CAUTION: BEFORE ATTEMPTING TO IGNITE YOUR BARBECUE, FOR YOUR SAFETY PLEASE CONDUCT A VISUAL CHECK TO ENSURE THAT THE BURNERS ARE ALIGNED WITH THE VALVES CORRECTLY, THAT ALL CONNECTIONS BETWEEN THE GAS SUPPLY LINE AND THE BARBECUE ARE TIGHTENED, AND FINALLY THAT A COMPLETE LEAK TEST IS COMPLETED.

CLEANING YOUR UNIVERSAL TUBE BURNERS

Perform at the start of the season, and at least twice in-season, more if the barbecue is being used frequently or year-round.

1. Remove the cooking grates, warming rack, heat plates and burners.
2. Remove the hardware used to assemble the burners.
3. Remove the tube burner.
4. Clean the burner port holes using a wire or paperclip to unplug the ports. Do not use tools that cause damage to or enlarge the port holes.

5. Use a venturi cleaning brush to clean the interior of the burner. Shake out any loose debris from the burner.
6. Use cotton swab to remove debris from the valve gas jet.
7. Re-install the tube burner using hardware removed. Ensure that the burners are installed correctly and firmly in place.